

## Desktop Profile

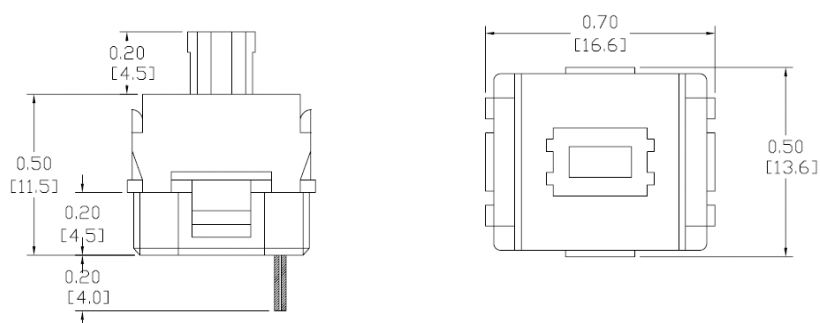

## Dimensions: Inches (mm)



## ELECTRICAL SPECIFICATIONS

ITEM	Description
Power Consumption	5 V DC, 50 mA
Isolation Resistance	$\geq 50 \text{ M}\Omega$ at DC 100 V
Circuit Resistance	The circuit resistance is under $250\Omega$ . Switch function stably and are qualified when it is under $1\text{K}\Omega$ . Test Conditions:Applying a static load 100g to the center of the switch,measured between and X-Y lines on the flat cable for 3 to 5 seconds,at standard condition.
Bounce Time	Under 10 ms. Test Conditions:Applying a load of actuating force to the center of the switch,In normal use(2 to 3 operations per sec),bounce should be tested at "ON" and "OFF".
Life	20M cycles and actuating force $\pm 30\%$ initial force.
Pretravel	$2.1 \pm 0.5 \text{ mm}$
Total Travel	$4.5 - 0.5 \text{ mm}$
Key Force	$55 \pm 10 \text{ grams}$
Autuation Trave	$> 2 \text{ mm}$
Resistance Force	Compress key of 10 kgs.
Withstanding Voltage	AC 100 V under 1 mA for 1 minute.

## MODEL NO. BSW 055WH

Operating Temp. Range	-10° to +70°C
Storage Temp. Range	-40° to +70°C
Relative Humidity	5% to 95%, non-condensing

### Mounting Options: Inches (mm)

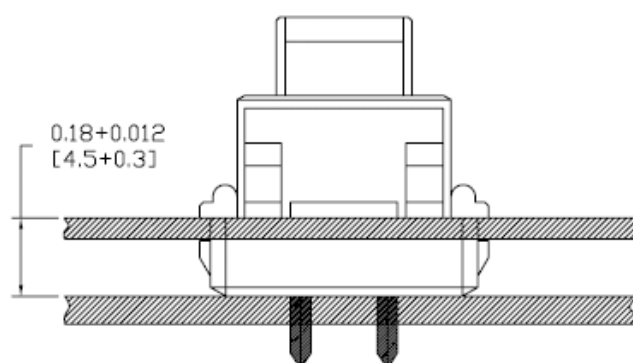
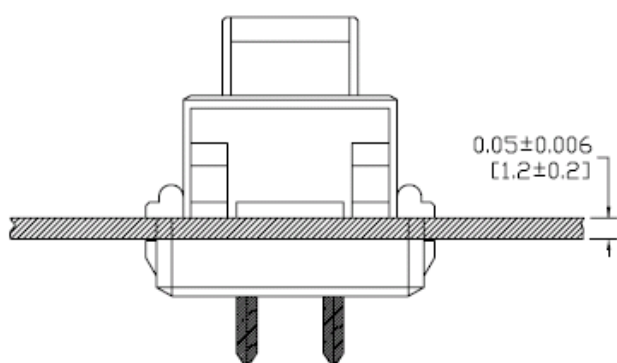

### Circuit Board Layouts: Inches (mm)

Grid line spacing = 0.05 inch

Keyswitch without fixation pins

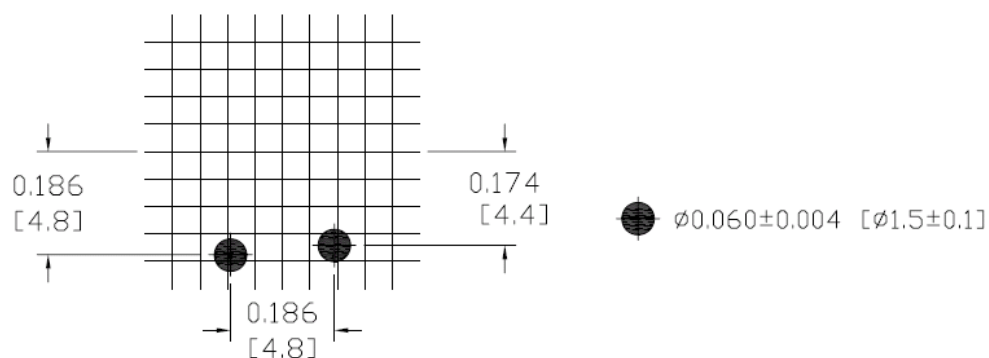

# MODEL NO. BSW 055WH

## Keycap Dimensions: Inches (mm)

0.948	[24.1]	Row E
0.930	[23.6]	Row A
0.894	[22.7]	Row B
0.864	[22.0]	Row D
0.852	[21.7]	Row C

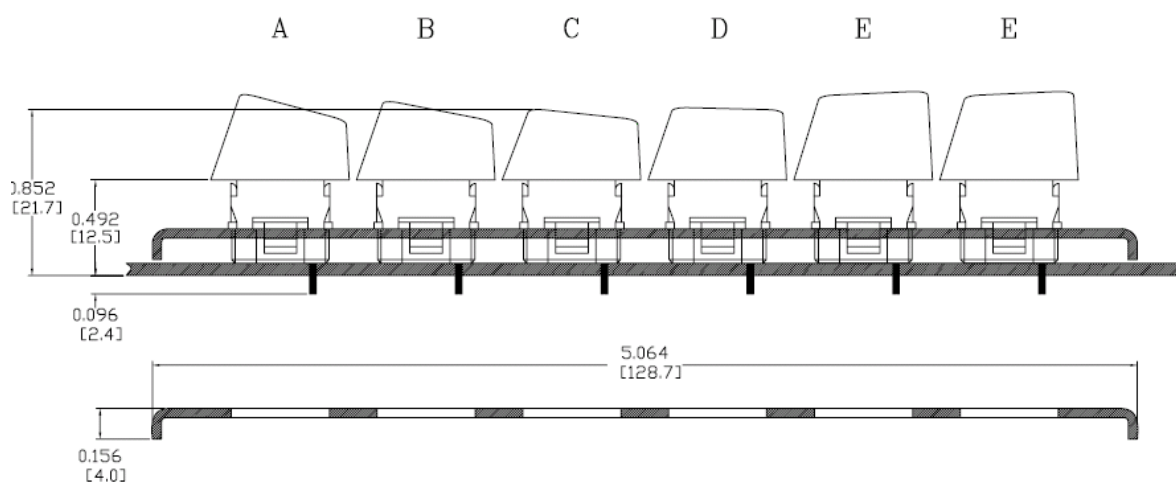
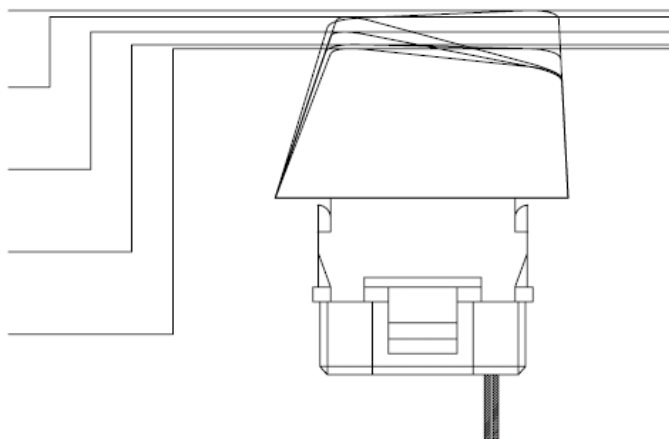

MODEL NO. BSW 055WH

**Keycap Operating travel :**

**Pretravel :  $2.1 \pm 0.5$ mm**

**Total travel :  $4.5 - 0.5$ mm**

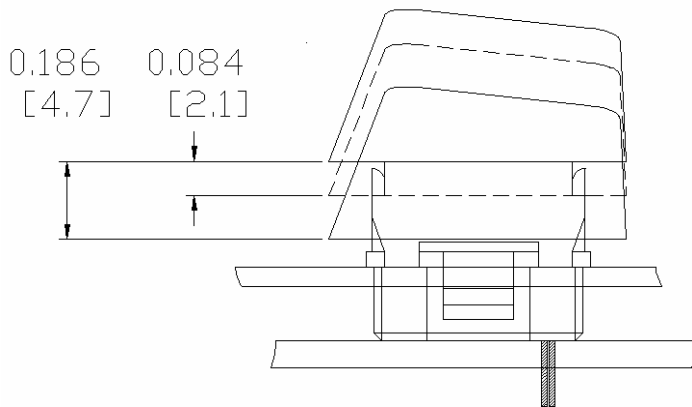

**Keycap tremble : Inches (mm)**

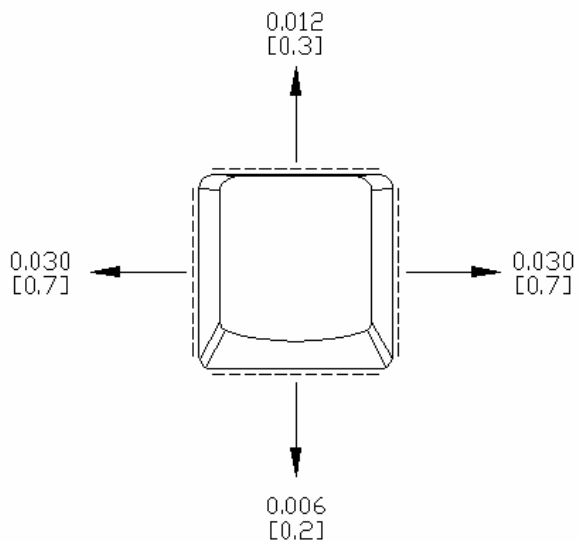

MODEL NO. BSW 055WH

**Metal Frame Cutout Dimensions: Inches (mm)**

